

MTZ Datasheet

Product Information

Product Data

Product Dimensions



MTZ Rapid Roll Operators



Product Features

- Integral Safety Gear.
- Hand Crank System.
- Safety Interlock Switch for Manual Operation.
- Integral Thermal Protection.
- I.P. 54 Environment Protection
- Electronic Limits as standard.
- Phosphor Bronze Worm Wheel.
- High starting Torque Industrial Duty Motor.
- Universal Mounting.

The MTZ range of rapid rolling door operators are supplied with either 0.75 kW, 1.1kW or 1.9kW 230V three phase brake motors. These models are fitted with a hand crank override system which enables the door to be manually operated in the event of mains failure and electronic limits as standard. Other powers and speeds are available on request.

Data/ Type	MTZ05	MTZ30				MTZ30				
Order Code	26-3590	21-3980	21-3981	21-3982	21-3983	21-3984	21-3985	21-3986	21-3987	21-3990
Torque (Nm)	70	250	160	130	90	270	160	130	90	200
Power (kW)	0.75	1.1(50Hz)				1.9(100Hz)				2.2(50Hz)
Output Speed (rpm)	90	25	45	60	90	45	90	120	180	90
Bore Dia. (mm) under speed	30	40				40				
Current (Amps)	2.4	5.0				8.7				6.5
Power Supply	230V / 1PH / 50HZ	230V / 1PH / 50HZ				230V / 1PH / 50HZ				
Environmental Protection	IP54	IP54				IP54				

MTZ 05 OPERATOR DIMENSIONS (30mm)

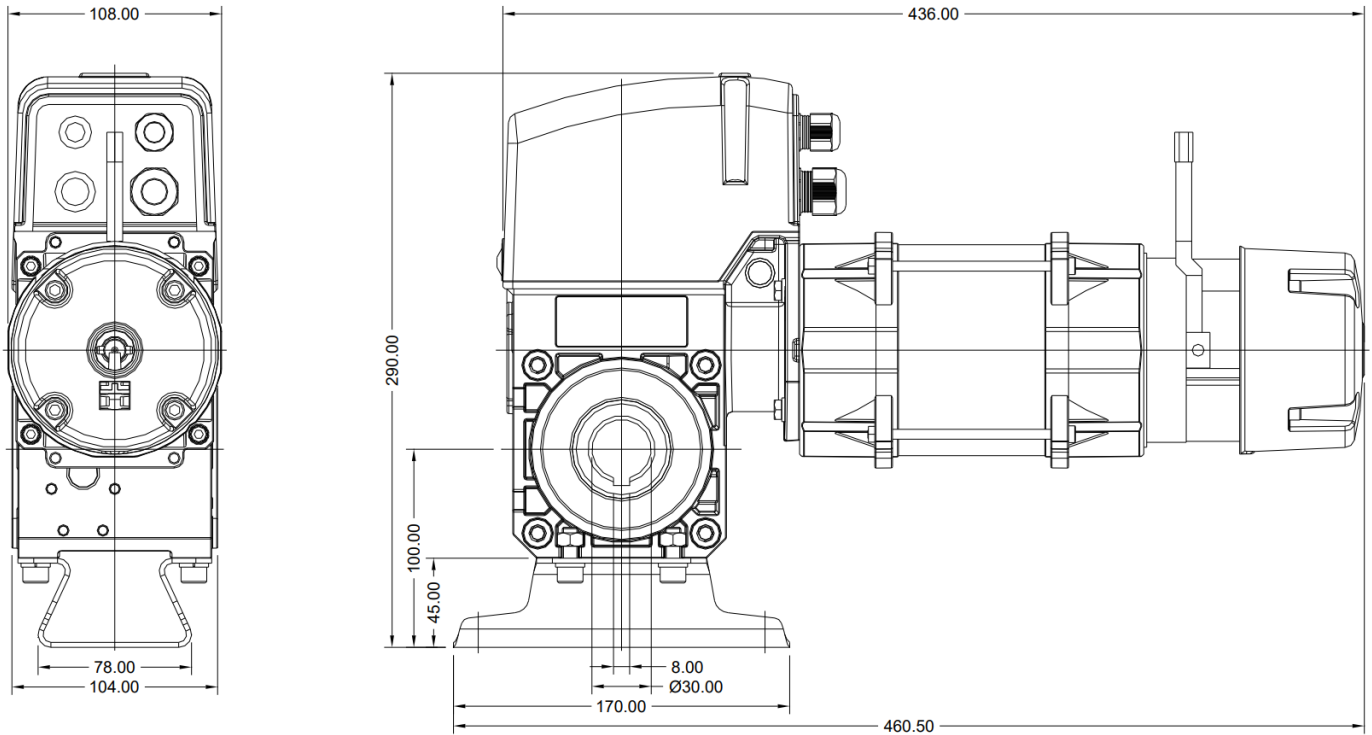

MTZ 3 OPERATOR DIMENSIONS (40mm)

